

ELECTRIC OUTWARD OPENING MECHANISM

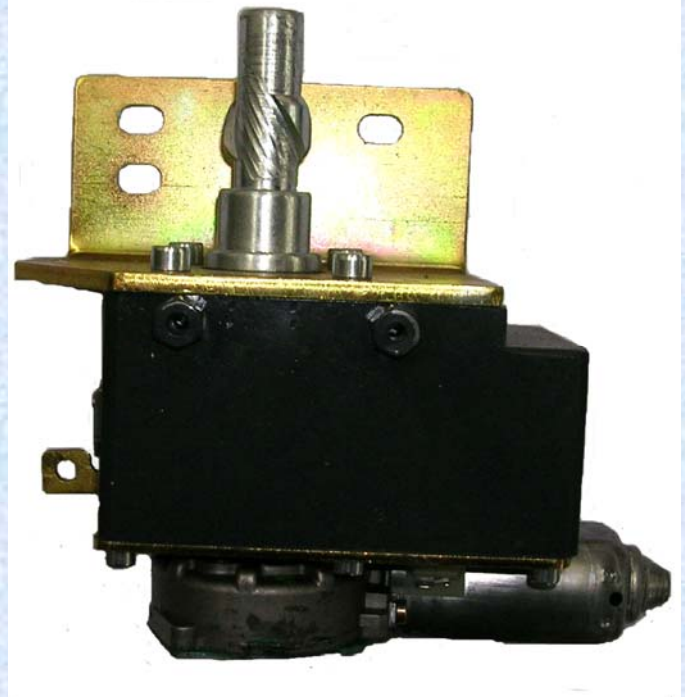

ELECTRIC MECHANISM

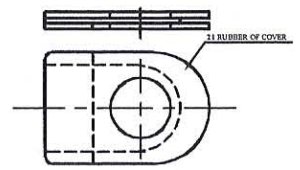
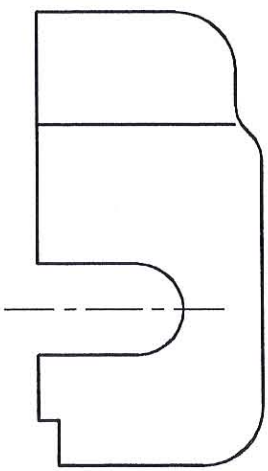
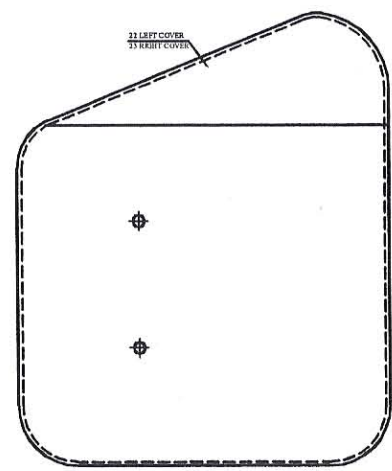
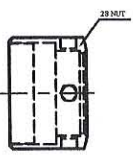
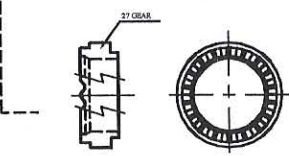
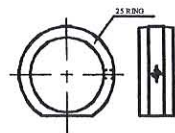
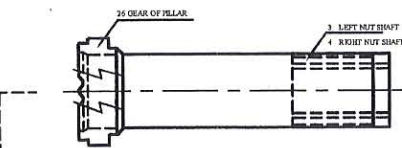
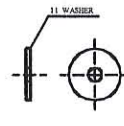
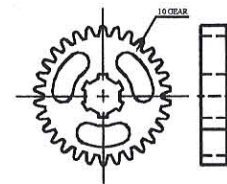
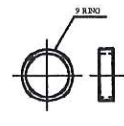
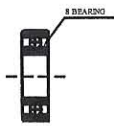
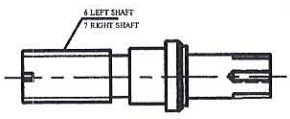
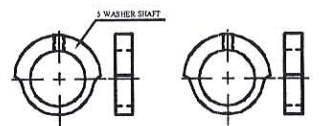
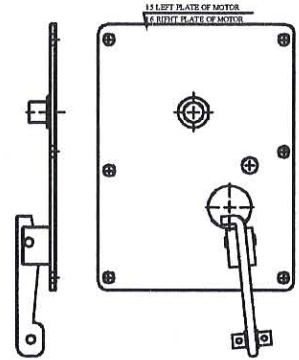
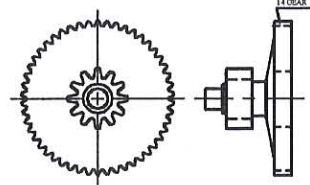
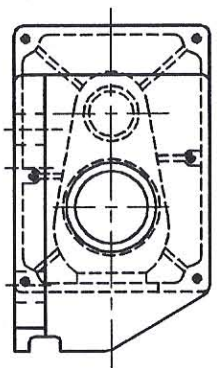
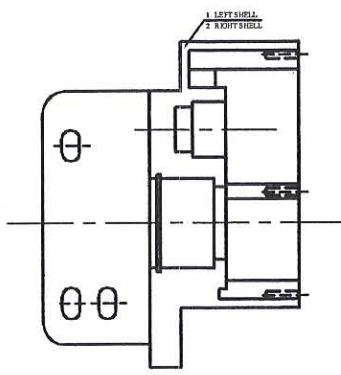
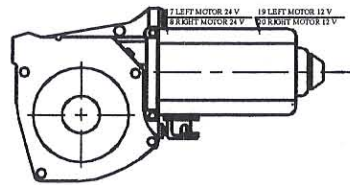
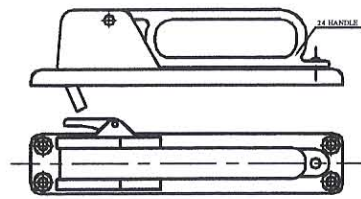
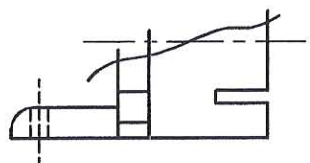

№	NAME	QTY	UNIT	№	NAME	QTY	UNIT
1	LEFT SHELL	1	PC	15	LEFT PLATE OF MOTOR	1	PC
2	RIGHT SHELL	1	PC	16	RIGHT PLATE OF MOTOR	1	PC
3	LEFT NUT SHAFT	1	PC	17	LEFT MOTOR 24 V	1	PC
4	RIGHT NUT SHAFT	1	PC	18	RIGHT MOTOR 24 V	1	PC
5	WASHER SHAFT	1	PC	19	LEFT MOTOR 12 V	1	PC
6	LEFT SHAFT	1	PC	20	RIGHT MOTOR 12 V	1	PC
7	RIGHT SHAFT	1	PC	21	LEFT COVER	1	PC
8	BEARING	2	PC	22	RIGHT COVER	1	PC
9	RING	1	PC	23	RUBBER OF COVER	1	PC
10	GEAR	1	PC				
11	WASHER	1	PC				
12	SCREW	1	PC				
13	BEARING	1	PC				
14	GEAR	1	PC				
15	LEFT PLATE OF MOTOR	1	PC				
16	RIGHT PLATE OF MOTOR	1	PC				
17	LEFT MOTOR 24 V	1	PC				
18	RIGHT MOTOR 24 V	1	PC				
19	LEFT MOTOR 12 V	1	PC				
20	RIGHT MOTOR 12 V	1	PC				
21	LEFT COVER	1	PC				
22	RIGHT COVER	1	PC				
23	RUBBER OF COVER	1	PC				
24	HANDLE	1	PC				
25	RING	1	PC				
26	GEAR OF PILLAR	1	PC				
27	GEAR	1	PC				
28	GEAR	1	PC				
29	GEAR	1	PC				
30	NUT	1	PC				

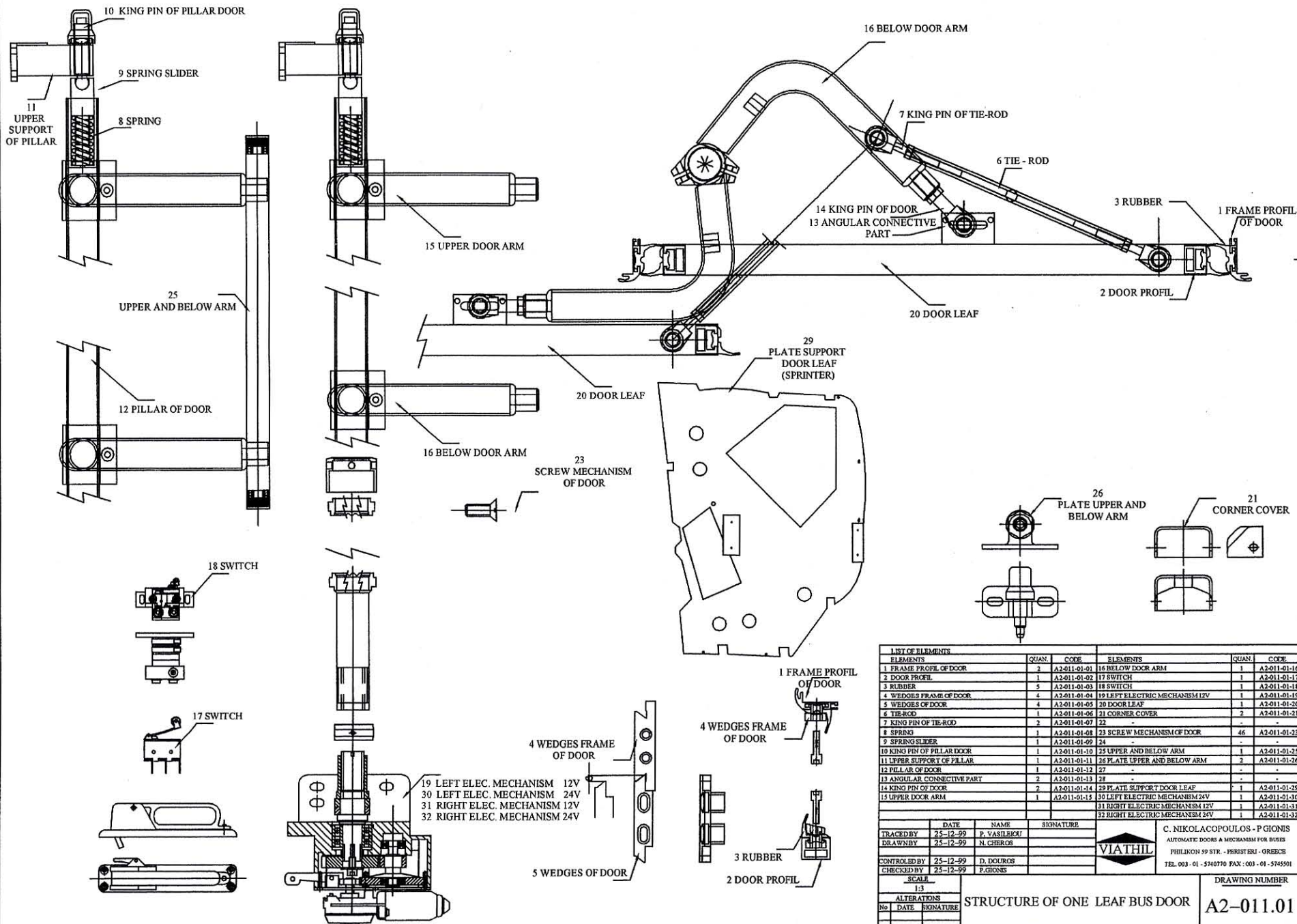

LIST OF ELEMENTS					
ELEMENTS	QUAN.	CODE	ELEMENTS	QUAN.	CODE
1 FRAME PROFIL OF DOOR	2	A2-011-01-01	16 BELOW DOOR ARM	1	A2-011-01-16
2 DOOR PROFIL	1	A2-011-01-02	17 SWITCH	1	A2-011-01-17
3 RUBBER	5	A2-011-01-03	18 SWITCH	1	A2-011-01-18
4 WEDGES FRAME OF DOOR	4	A2-011-01-04	19 LEFT ELECTRIC MECHANISM 12V	1	A2-011-01-19
5 WEDGES OF DOOR	4	A2-011-01-05	20 DOOR LEAF	1	A2-011-01-20
6 TIE-ROD	1	A2-011-01-06	21 CORNER COVER	2	A2-011-01-21
7 KING PIN OF TIE-ROD	2	A2-011-01-07	22	-	-
8 SPRING	1	A2-011-01-08	23 SCREW MECHANISM OF DOOR	46	A2-011-01-23
9 SPRING SLIDER	1	A2-011-01-09	24	-	-
10 KING PIN OF PILLAR DOOR	1	A2-011-01-10	25 UPPER AND BELOW ARM	1	A2-011-01-25
11 UPPER SUPPORT OF PILLAR	1	A2-011-01-11	26 PLATE UPPER AND BELOW ARM	2	A2-011-01-26
12 PILLAR OF DOOR	1	A2-011-01-12	27	-	-
13 ANGULAR CONNECTIVE PART	2	A2-011-01-13	28	-	-
14 KING PIN OF DOOR	2	A2-011-01-14	29 PLATE SUPPORT DOOR LEAF	1	A2-011-01-29
15 UPPER DOOR ARM	1	A2-011-01-15	30 LEFT ELECTRIC MECHANISM 24V	1	A2-011-01-30
			31 RIGHT ELECTRIC MECHANISM 12V	1	A2-011-01-31
			32 RIGHT ELECTRIC MECHANISM 24V	1	A2-011-01-32

DATE	NAME	SIGNATURE
25-12-99	P. VASILEIU	
25-12-99	N. CHERCOS	
25-12-99	D. DOURCOS	
25-12-99	P. GHONIS	

TRACED BY	25-12-99	P. VASILEIU		C. NIKOLACOPOULOS - P. GHONIS AUTOMATIC DOORS & MECHANISM FOR BUSES PHILIKON 59 STR. - FERISTERI - GREECE TEL. 003 - 01 - 5740770 FAX: 003 - 01 - 5745501
DRAWN BY	25-12-99	N. CHERCOS		
CONTROLLED BY	25-12-99	D. DOURCOS		
CHECKED BY	25-12-99	P. GHONIS		
SCALE			DRAWING NUMBER	
1:3			A2-011.01	
ALTERATIONS			STRUCTURE OF ONE LEAF BUS DOOR	
No.	DATE	SIGNATURE		

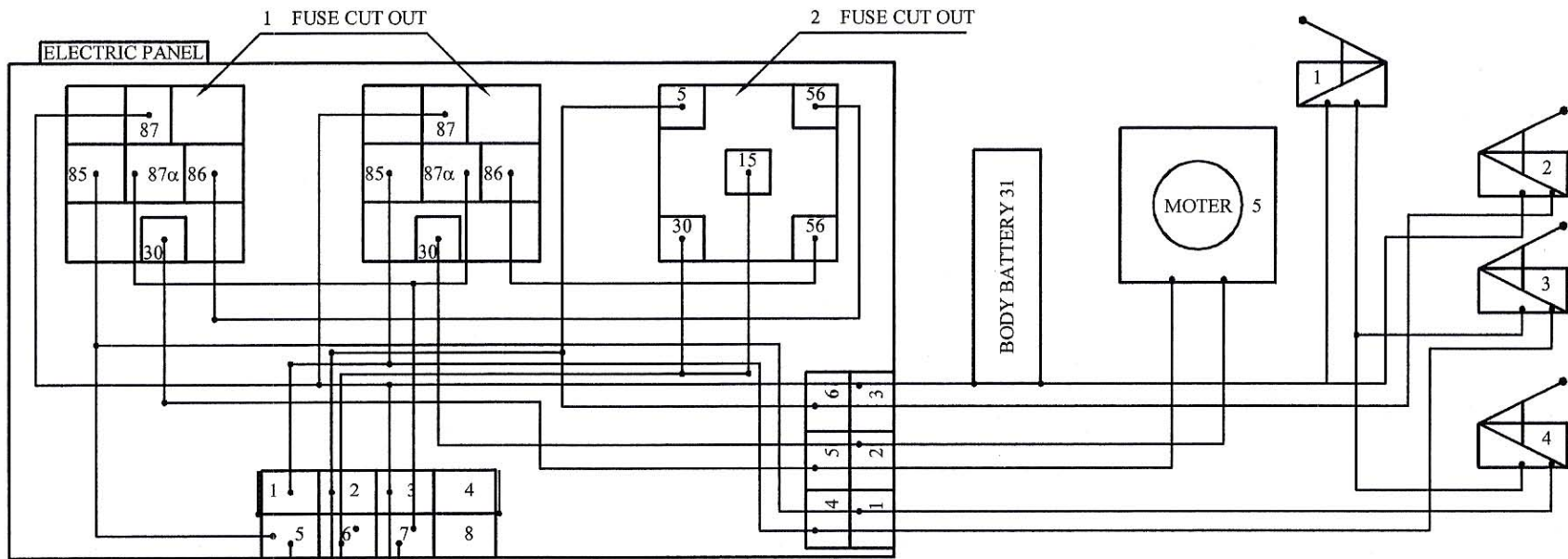

EIGHT POLE PLUG	
EMPTY	1
LAMP DOOR	5
SWITCH DOOR	2
EMPTY	4
BODY 31	3
15 CURRENT F 8 A	6
30 CURRENT F 20 A	7
EMPTY	8
CURRENT ELECTRIC PANEL	

SIX POLE PLUG	
OPEN DOOR	1
CLOSE DOOR	4
DOOR MOTER	5
DOOR MOTER	2
BODY 31	3
AUTOMAT. DOOR	6
CURRENT ELECTRIC BOOTLE	

1	UNSAFETY MOTER
2	AUTOMAT. DOOR
3	CLOSE DOOR
4	OPEN DOOR
5	DOOR MOTER
6	SWITCH DOOR
7	LAMP DOOR

LIST OF ELEMENTS		QUAN.	CODE
1	FUSE CUT OUT 12V-24V	2	A3-001-01-01
2	FUSE CUT OUT 12V-24V	1	A3-001-01-02

TRACED BY	DATE	NAME	SIGNATURE
DRAWN BY	26-07-01	J.KOURASI	
CONTROLLED BY		C.NIKOLACOPOULOS	
CHECKED BY		P.GIONIS	

SCALE	
1:1	
ALTERATIONS	
No	DATE SIGNATURE

	C. NIKOLACOPOULOS - P GIONIS AUTOMATIC DOORS & MECHANISM FOR BUSES PHILIKON 59 STR. - PERISTERI - GREECE TEL. 003 - 01 - 5740770 FAX: 003 - 01 - 5745501
	DRAWING NUMBER <h1 style="margin: 0;">A3-001.01</h1>

ELECTRIC DIAGRAM OF DOOR